



Tipologia attacchi flangiati

Flanged connection type

PN6 entrata / uscita
PN16 entrata / uscita
PN6 entrata / PN16 uscita
PN16 entrata / PN6 uscita

NP6 inlet / outlet
NP16 inlet / outlet
NP6 inlet / NP16 outlet
NP16 inlet / NP6 outlet

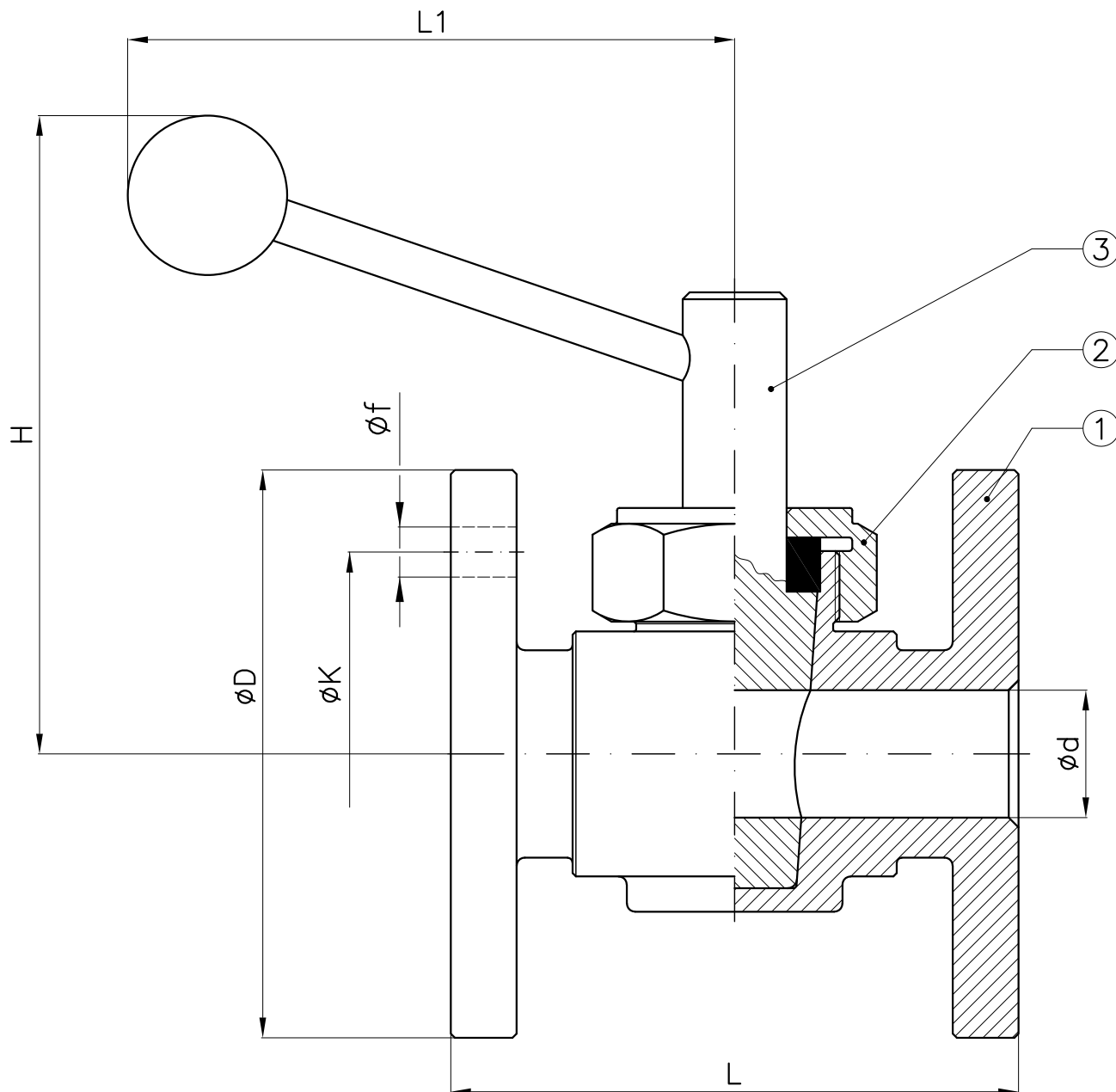

DN	d	H (~)	L	L1	Max Weight (Kg)	PN6				PN16			
						D	K	f	Holes No. f	D	K	f	Holes No. f
25	15	100	95	100	3.5	100	75	11	4	115	85	14	4
40	25	130	120	120	8	130	100	14	4	150	110	18	4

Combinazione materiali standard - Standard materials Combination		
316/316		
ITEM	DENOMINAZIONE DENOMINATION	MATERIALE MATERIAL
01	Body	Stainless steel AISI316 UNI EN10088
02	Bonnet	Stainless steel AISI316 UNI EN10088
03	Plug	Stainless steel AISI316 UNI EN10088
Nota: Combinazioni materiali non standard a richiesta Note: Non standard materials combinations on request		