



Rubinetti a maschio a 3 vie PN6 e PN16

Three way cocks NP6 and NP16

Tab.168

Conform to:
UNI EN1092

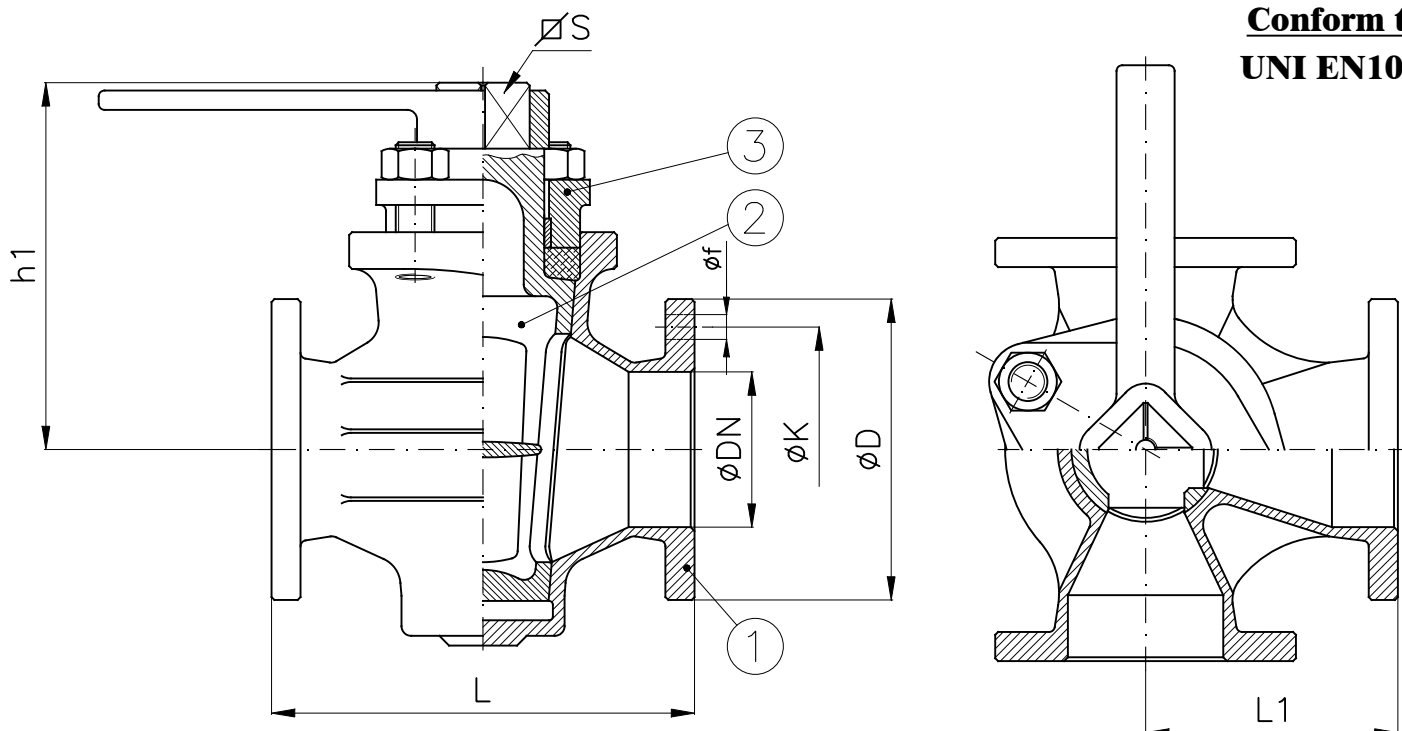

Ghisa – cast iron					PN6 – NP6					PN16 – NP16				
DN	L	L1	h1	S	D	K	f	Holes No. f	Weight (Kg.)	D	K	f	Holes No. f	Weight (Kg.)
25	150	75	120	22	100	75	11	4	4.8	115	85	14	4	6
32	180	90	125	24	120	90	14	4	7.3	140	100	18	4	9
40	190	95	145	27	130	100	14	4	9.7	150	110	18	4	11.5
50	205	102.5	145	27	140	110	14	4	11.7	165	125	18	4	15
65	240	120	180	32	160	130	14	4	17	185	145	18	4	21
80	260	130	190	36	190	150	18	4	23	200	160	18	8	26
100	320	160	230	50	210	170	18	4	34.5	220	180	18	8	39
125	355	177.5	300	61	240	200	18	8	61	250	210	18	8	67

Bronzo – Bronze					PN6 – NP6					PN16 – NP16				
DN	L	L1	h1	S	D	K	f	Holes No. f	Weight (Kg.)	D	K	f	Holes No. f	Weight (Kg.)
15	100	70	65	16	80	55	11	4	5.7	95	65	14	4	7
20	100	70	65	16	90	65	11	4	6	105	75	14	4	7
25	100/130	70/65	65	16	100	75	11	4	6.8	115	85	14	4	8
32	130/160	80/95	110	19	120	90	14	4	8.3	140	100	18	4	10
40	165	100	118	19	130	100	14	4	10	150	110	18	4	12
50	175	105	137	26	140	110	14	4	12	165	125	18	4	15
65	190/220	120/110	170	32	160	130	14	4	14	185	145	18	4	18
80	220	130	195	36	190	150	18	4		200	160	18	8	
100	250	150	210	38	210	170	18	4		220	180	18	8	

Combinazione materiali standard – Standard materials Combination			
		G/O	B/O
ITEM	DENOMINAZIONE DENOMINATION	MATERIALE MATERIAL	MATERIALE MATERIAL
01	Body	Cast iron UNI EN1561 EN-GJL-250	Bronze UNI EN1982 G-CuSn5Zn5Pb5
02	Plug	Brass CW617N (OT58)	Brass CW617N (OT58)
03	Gland	Cast iron UNI EN1561 EN-GJL-250	Bronze UNI EN1982 G-CuSn5Zn5Pb5
Nota: Combinazioni materiali non standard a richiesta Note: Non standard materials combinations on request			