



RF FLANGES: A

FF FLANGES: B

**Conform to:**

**UNI EN1092**

**DIN 3202**

**Esecuzioni a richiesta**  
**On request executions**

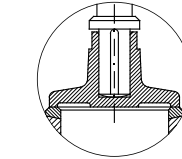
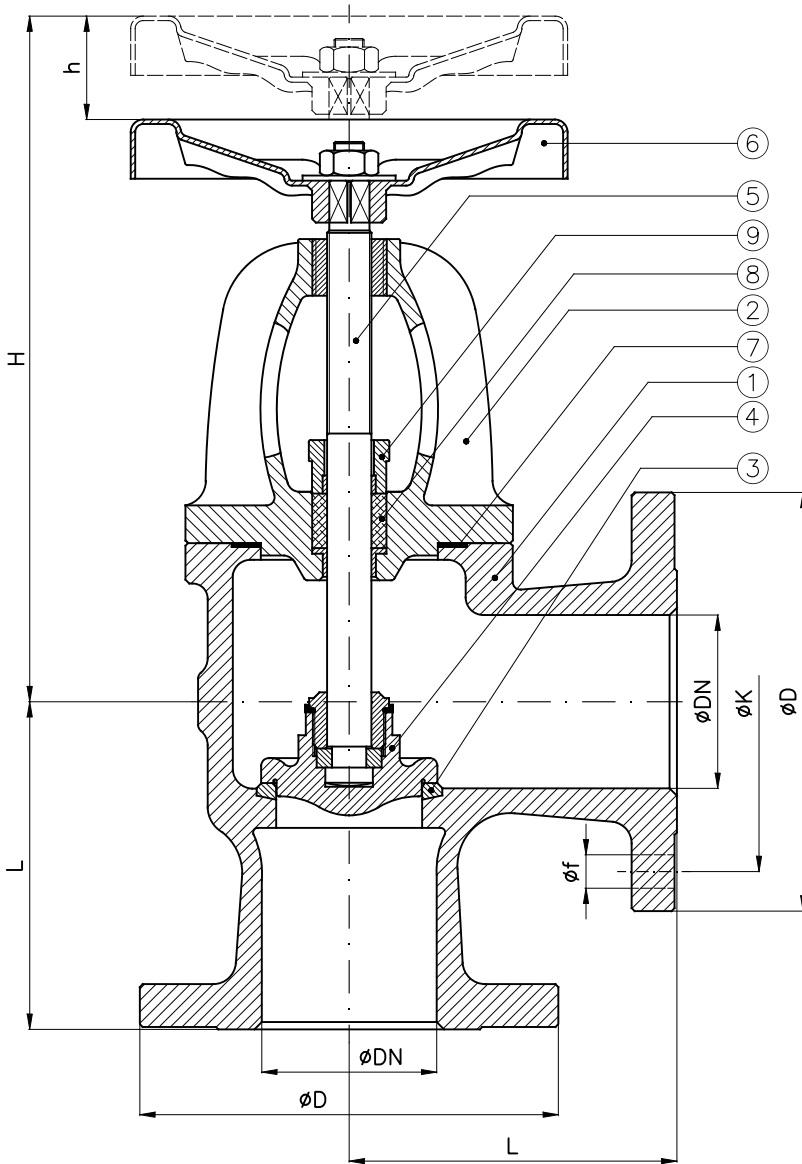

1) Otturatore semiautomatico  
SDNR disc

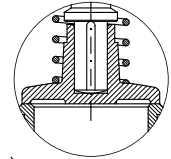

2) Otturatore semiautomatico con molla  
SDNR disc with spring loaded

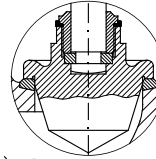

3) Otturatore di regolazione tronco conico  
Tapered frustum regulating disc

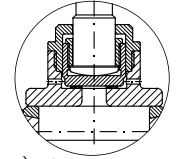

4) Otturatore bilanciato  
Balanced disc

DN	H (~)	h (~)	L	D	K	f	Holes NO. f	Weight (Kg)
15	215	10	85	95	65	14	4	5.3
20	220	10	85	105	75	14	4	6
25	230	15	90	115	85	14	4	7
32	245	20	105	140	100	18	4	9
40	280	25	115	150	110	18	4	12
50	290	30	125	165	125	18	4	15
65	325	35	145	185	145	18	8	25
80	355	35	155	200	160	18	8	28
100	380	40	175	235	190	22	8	45
125	420	50	200	270	220	26	8	63
150	460	65	225	300	250	26	8	70
175	495	70	250	350	295	29	12	129
200	575	80	275	375	320	29	12	145
250	655	85	325	450	385	33	12	
300	770	100	375	515	450	33	16	

Combinazione materiali standard – Standard materials Combination

ITEM	DENOMINAZIONE DENOMINATION	A/316 MATERIALE MATERIAL	A/420 MATERIALE MATERIAL	CF8M/316 MATERIALE MATERIAL	B/316 MATERIALE MATERIAL	B/B MATERIALE MATERIAL
01	Body	Cast steel GP240-GH UNI EN10213	Cast steel GP240-GH UNI EN10213	Stainless steel CF8M ASTM A351	Bronze UNI EN1982 G-CuSn5Zn5Pb5	Bronze UNI EN1982 G-CuSn5Zn5Pb5
02	Bonnet	Cast steel GP240-GH UNI EN10213	Cast steel GP240-GH UNI EN10213	Stainless steel CF8M ASTM A351	Bronze UNI EN1982 G-CuSn5Zn5Pb5	Bronze UNI EN1982 G-CuSn5Zn5Pb5
03	Body seat	Stainless steel AISI316 UNI EN10088	Stainless steel AISI420 UNI EN10088	Stainless steel AISI316 UNI EN10088	Bronze UNI EN1982 G-CuSn5Zn5Pb5	Bronze UNI EN1982 G-CuSn5Zn5Pb5
04	Disc (≤ DN80)	Stainless steel AISI316 UNI EN10088	Stainless steel AISI420 UNI EN10088	Stainless steel AISI316 UNI EN10088	Stainless steel AISI316 UNI EN10088	Bronze UNI EN1982 G-CuSn5Zn5Pb5
04	Disc (≥ DN100)	Cast steel GP240-GH UNI EN10213 plus AISI316 facing welding	Cast steel GP240-GH UNI EN10213 plus AISI308 facing welding	Stainless steel CF8M ASTM A351	Stainless steel CF8M ASTM A351	Bronze UNI EN1982 G-CuSn5Zn5Pb5
05	Stem	Stainless steel AISI316 UNI EN10088	Stainless steel AISI420 UNI EN10088	Stainless steel AISI316 UNI EN10088	Stainless steel AISI316 UNI EN10088	Brass CW617N (OT58)
06	Handwheel	Sheet of carbon steel	Sheet of carbon steel	Sheet of carbon steel	Sheet of carbon steel	Sheet of carbon steel
07	Gasket	Planiflex KG carbo/C PF81	Planiflex KG carbo/C PF81	Planiflex KG carbo/C PF81	Planiflex KG carbo/C PF81	Planiflex KG carbo/C PF81
08	Packing	Carbograph GR8800	Carbograph GR8800	Carbograph GR8800	Carbograph GR8800	Carbograph GR8800
09	Gland bushing	Steel Fe360B (S235JRC) UNI EN10025	Steel Fe360B (S235JRC) UNI EN10025	Stainless steel AISI316 UNI EN10088	Brass CW509L (OT60)	Brass CW509L (OT60)

Nota: Combinazioni materiali non standard a richiesta  
 Note: Non standard materials combinations on request