

Tab.113.1A PN10M.M.I.
comandata (SDSL)
with fixed disc (SDSL) UNAV 9328-9329

Tab.113.2A PN10M.M.I.
semiautomatica (SDNR)
with loose disc (SDNR) UNAV 9332-9333

Flangia quadra
Square flange

Flangia tonda
Round flange

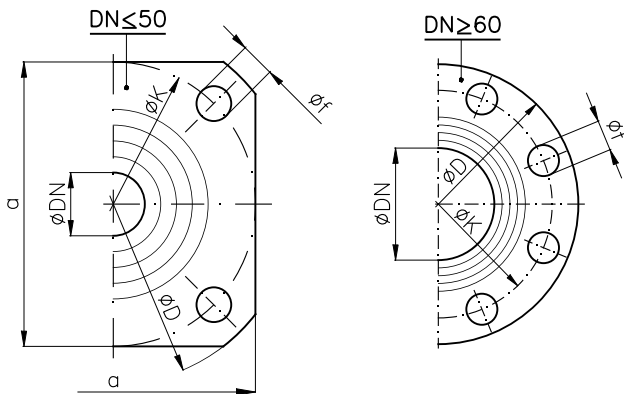

Combinazione materiali standard - Standard materials Combination

ITEM	DENOMINAZIONE DENOMINATION	A/316	CF8M/316
		MATERIALE MATERIAL	MATERIALE MATERIAL
01	Body	Cast steel GP240-GH UNI EN10213	Stainless steel CF8M ASTM A351
02	Bonnet	Cast steel GP240-GH UNI EN10213	Stainless steel CF8M ASTM A351
03	Body seat	Stainless steel AISI316 UNI EN10088	Stainless steel AISI316 UNI EN10088
04	Disc (≤ DN80)	Stainless steel AISI316 UNI EN10088	Stainless steel AISI316 UNI EN10088
04	Disc (≥ DN100)	Cast steel GP240-GH UNI EN10213 plus AISI316 facing welding	Stainless steel CF8M ASTM A351
05	Stem	Stainless steel AISI316 UNI EN10088	Stainless steel AISI316 UNI EN10088
06	Handwheel	Sheet of carbon steel	Sheet of carbon steel
07	Handle	Steel A37 UNI EN10217-1	Steel A37 UNI EN10217-1
08	Gasket	Planiflex KG carbo/C PF81	Planiflex KG carbo/C PF81
09	Packing	Carbograph GR8800	Carbograph GR8800
10	Gland bushing	Steel Fe360B (S235JRC) UNI EN10025	Stainless steel AISI316 UNI EN10088

DN	a	C1	D1	H SDSL (~)	h SDSL	H1 SDNR (~)	h1 SDNR	L	D	K	f	Holes NO. f	Weight (Kg)
40	85	125	125	220	20	260	16	75	110	85	14	4	6.3
50	95	125	125	230	24	260	17	85	120	95	14	4	7
60	-	175	175	255	28	280	16	100	135	110	14	6	10
65/70	-	175	175	275	32	305	18	105	140	115	14	6	11.2
80	-	175	175	285	35	310	20	110	155	130	14	8	13.9
90	-	200	200	305	38	330	24	120	170	145	14	8	16.5
100	-	200	200	320	45	350	28	130	175	150	14	8	24
125	-	225	225	360	54	385	32	145	200	175	14	12	29
150	-	225	300	385	62	410	38	160	230	205	14	12	38
175	-	250	400	445	74	465	45	190	270	240	18	12	60
200	-	250	400	465	82	480	50	220	295	265	18	12	65

Nota: Combinazioni materiali non standard a richiesta
Note: Non standard materials combinations on request